

# RCON

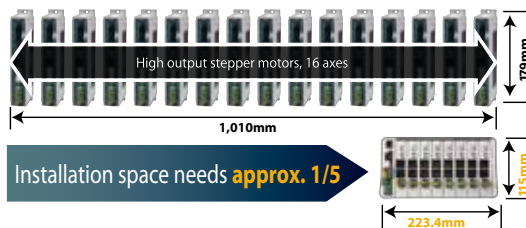

POINT  
**01**

Installation space takes **approx. 1/5** of the conventional units



POINT  
**03**

Highly extendable  
**Unit-linkage system**



link-up connector

POINT  
**02**

Contributing to **cost reduction**

**[Connection of 16 axes to the PCON ]**  
PCON-CB (CC-link) x 16 units

**[Connection of 16 axes to the RCON]**  
RCON-GW-CC x 1 unit  
RCON-PC-2 x 8 units



POINT  
**04**

Compatible with all  
**24V type actuator**

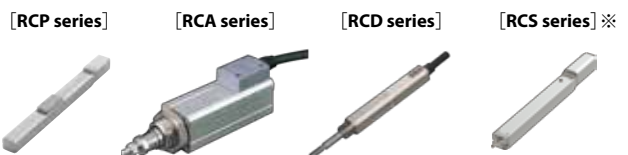

\* Need one expansion unit and one SCON-CB.

## System configuration

# System

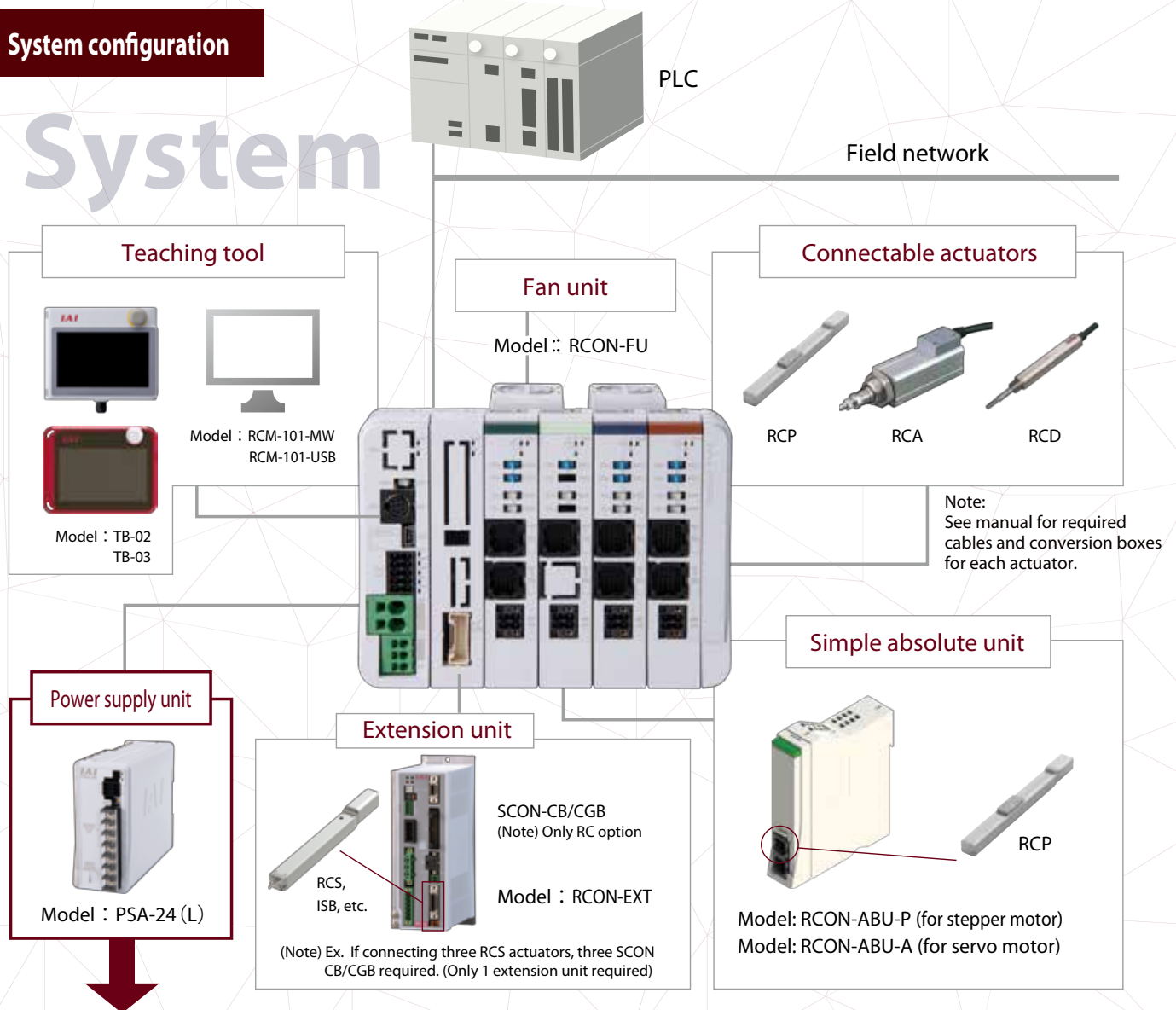

## Power supply unit

The power supply unit has the same height as RCON's, which can easily be installed next to the controller. When used "with a fan," it can be used for a continuous rating of 330W and an instant peak of 408W.



Item	Specifications	
	AC100V	AC200V
Power source voltage range	AC100V~AC230V±10%	
Input power current	3.9A or less	1.9A or less
Power supply capacity	without fan : 250VA	without fan : 280VA
	with fan : 390VA	with fan : 380VA
Rush current *1	without fan : 17A (typ)	without fan : 34A (typ)
	with fan : 27.4A (typ)	with fan : 54.8A (typ)
Calorific value	28.6W	20.4W
Output voltage range *2	24V±10%	
Continuous rated output	without fan : 8.5A (204W) 、 with fan : 13.8A (330W)	
Peak output	17A (408W)	
Efficiency	86% or higher	90% or higher

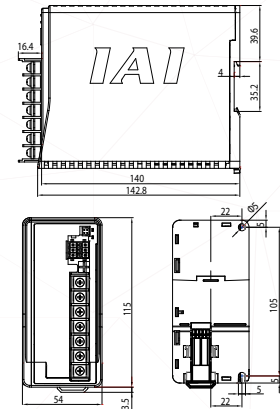

\*The height of the unit with fan is 16mm taller.

### 【Power supply unit】

Model : PSA-24 (without fan)  
Model : PSA-24L (with fan)

\*1: The pulse duration of the rush current is 5ms or shorter.

\*2: This power supply has a feature of changing output voltage depending on the load in order to enable parallel operation. Therefore, this power supply is dedicated to IAI controllers.

# Power supply

## Gateway unit

For connection with field networks.  
It can be connected with the 7 networks below.



Gateway unit

Terminal unit

### ■ Dimensions

[Gateway unit]

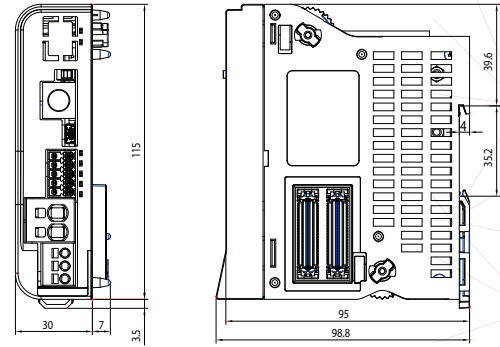

[Terminal unit]

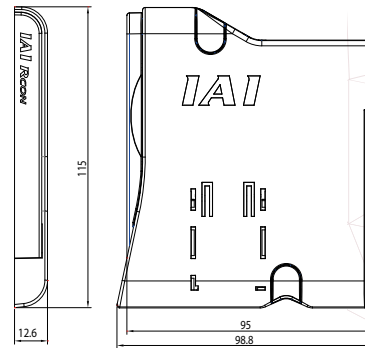

[Gateway unit one terminal unit included unless "-TRN" (no terminal unit is specified)]

Model	Type
RCON-GW-CC	CC-Link
RCON-GW-DV	DeviceNet
RCON-GW-PR	PROFIBUS-DP
RCON-GW-EC	EtherCAT
RCON-GW-EP	EtherNet/IP
RCON-GW-PRT	PROFINET-I/O
RCON-GW-CIE	CC-Link IE

Ex. RCON-GW-EP-FU2 (Gateway unit for EP option + terminal unit + 2 of fan units)  
RCON -GW-CC-FU1-TRN (Gateway unit for CC-link + one of fan unit + no terminal unit)  
\* fan unit and terminal unit can be also purchased individually.

## Driver unit

Controller units to control actuators.  
A single unit can be connected with up to 2 axes.



RCON-PC/PCF • • • connection with the RCP series  
RCON-AC • • • connection with the RCA series  
RCON-DC • • • connection with the RCD series

## Driver unit

[Driver unit]

Model	Type
RCON-PC-1	Stepper motor, 1 axis
RCON-PC-2	Stepper motors, 2 axes
RCON-PCF-1	High thrust stepper motor, 1 axis
RCON-AC-1	Servo motor, 1 axis
RCON-AC-2	Servo motors, 2 axes
RCON-DC-1	DC brushless motors, 1 axis
RCON-DC-2	DC brushless motors, 2 axes

### ■ Dimensions

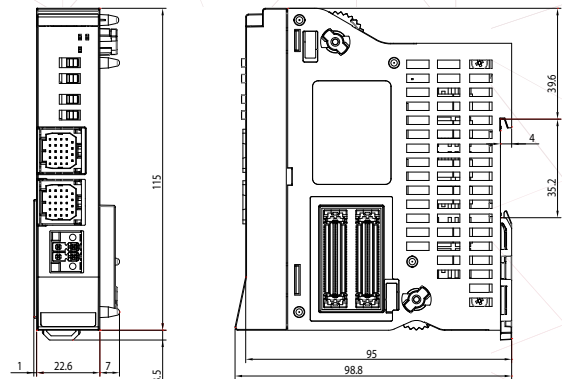

### ⚠ Warning

RCON always requires one gateway unit and one terminal unit. One of fan unit required for every 2 driver units. (Ex. 2 fan units for 4 driver units, 1 for 3 driver units.)

## Specifications

Item	Specifications		
Power source voltage range	DC24V±10%		
Control power supply	Gateway unit	0.8A (without Ethernet)	
	P/A/D driver unit	Without brake	0.2A
		With brake for 1 axis	0.4A
		With brake for 2 axes	0.6A
	Extension unit	0.1A	
P/A simple absolute unit	0.2A		
Motor power	Stepper motor	20P/28P	Maximum 0.8A
		28P/35P/42P/56P	High output effective rated 2.3A High output effective maximum 3.9A High output non-effective maximum 1.9A
		56P/56SP/60P/86P	Maximum 5.7A
	AC servo motor	5W	Rated 1.0A Maximum 3.3A
		10W	Rated 1.3A Maximum 4.4A
		20W	Rated 1.3A Maximum 4.4A
		30W	Rated 1.3A Maximum 4.0A
	DC brushless motor	3W	Rated 0.7A Maximum 1.5A
Rush power	RCON-PC 8.3A RCON-PCF 10A RCON-AC 10A RCON-DC 10A		
Calorific value	RCON-PC (with power control) 8W RCON-PC (without power control) 5W RCON-PCF 19.2W RCON-AC 4.5W RCON-DC 3W		
Preventive & predictive maintenance function	Drop in electrolytic condenser capacity and fan rpm		
Operating ambient temperature	0 to 55°C. For simple absolute unit: 0 to 40°C		
Operating ambient humidity	Relative humidity less than 85%. Non-condensing.		
Ambient humidity for storage	-20 to +70°C. For simplified absolute unit: 0 to 40°C		
Operating ambient atmosphere	Not exposed to corrosive gases and especially dusts.		
Degree of protection	IP20		
Overseas certification	CE and UL (expected to obtain)		

Note: See manual for required cables and conversion boxes for each actuator.

### IAI America, Inc.

**Headquarters:** 2690 W. 237th Street, Torrance, CA 90505 (800) 736-1712  
**Chicago Office:** 110 E. State Pkwy, Schaumburg, IL 60173 (800) 944-0333  
**Atlanta Office:** 1220 Kennestone Circle, Suite 108, Marietta, GA 30066 (888) 354-9470

[www.intelligentactuator.com](http://www.intelligentactuator.com)

### IAI Industrieroboter GmbH

Ober der Röth 4, D-65824 Schwalbach am Taunus, Germany

### IAI (Shanghai) Co., Ltd.

Shanghai Jiahua Business Center A8-303, 808, Hongqiao Rd., Shanghai 200030, China

### IAI Robot (Thailand), CO., Ltd.

825 PhairojKijja Tower 12th Floor, Bangna-Trad RD., Bangna, Bangna, Bangkok 10260, Thailand