

swing clamps

SC Series
Swing Clamp



NUMATICS

Table of Contents

NUMATICS®

SC Series Swing Clamps	3-6
Features and Benefits	3
How To Order	3
Dimensions and Technical Specifications	4
Switch Information	5-6

Air-Oil Systems, Inc. www.airoil.com



Numatics Motion Control SC-Series Swing Clamps combine linear and rotary motions. A specially machined spline internal to the piston rod develops the combined motions. When the clamp is pressurized to extend it moves linear, removing the clamp tooling from the clamped surface as not to damage the clamped surface. After completing the linear travel rotation occurs swinging the clamp arm away from the work holding area. When clamping the opposite motions occur.

A. Body

Hardcoat anodized aluminum, light weight, durable Teflon impregnated, lubricated, maximizes seal life.

B. Rod Bushing

Large bearing area provides maximum rod support side load protected.

C. Piston Rod

Hardened electroless nickel plated corrosion resistant, durable low wearing surface.

D. Clamp Arm

Taper mounted convenient arm adjustment, 360 degree adjustment.

E. Mounting Surface

Convenient location precision machined to accept standard industrial fasteners.



How to Order

SC 025 A 1 6 D X

Bore Size

025 = 25 mm
032 = 32 mm
040 = 40 mm
050 = 50 mm
063 = 63 mm

Arm Rotation

A = CW
B = CCW

Clamp Arm

1 = Single
2* = Double
*Not available on SC025.

Special Options

X = No Options

Sensing Position

A = Clamp
B = Unclamp
C = Clamp and Unclamp
D = No Sensing
E = Magnetic Piston - No Sensing

Sensing Type

Standard Cord Set
1 = Hall Effect - PNP (sourcing)
2 = Hall Effect - NPN (sinking)
3 = Reed Switch
6 = No Sensing
Quick Disconnect Cord Set
Z = Hall Effect - PNP (sourcing)
Y = Hall Effect - NPN (sinking)
X = Reed Switch

See page 5.

Sensing Kits

STANDARD CORD SET SWITCH		PART NO.
Hall Effect PNP (Sourcing)		HPNPS31
Hall Effect NPN (Sinking)		HNPNS32
Reed Switch		RSS02
QUICK DISCONNECT CORD SET		PART NO.
Hall Effect PNP (Sourcing)		HPNPQ31
Hall Effect NPN (Sinking)		HNPNQ32
Reed Switch		RSQ02
90° 5 meter cable		PXC90
Straight 5 meter cable		PXCST



SC Series Swing Clamps

NUMATICS®

SC Series

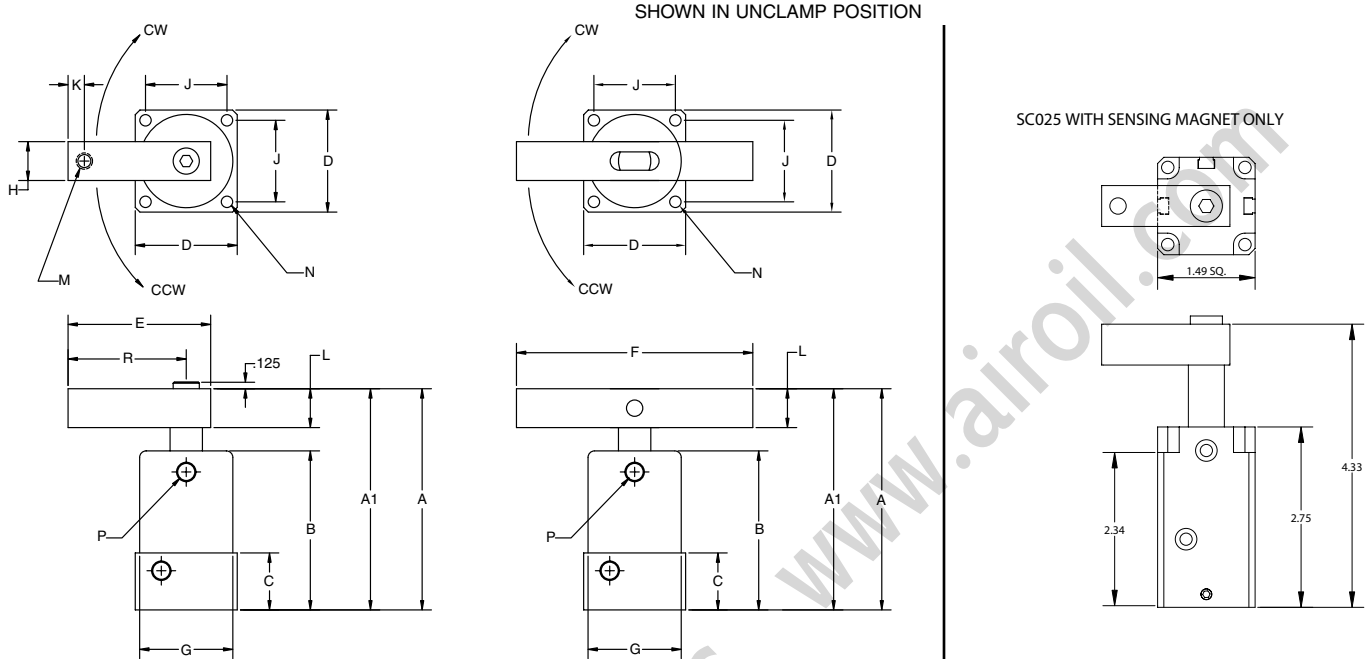

MODEL	RETRACT A*	EXTEND A1*	B*	C	D	E	F	G	H	J	K	L	M	N	P	R
SC025**	3.27 (83.0)	4.13 (105.0)	2.55 (65.0)	0.90 (23.0)	1.49 (38.0)	1.96 (50.0)	—	1.37 (35.0)	.62 (15.9)	1.18 (30.0)	0.25 (6.5)	0.62 (15.9)	M6	.18 (4.7)	M5	1.61 (41.0)
SC032	4.00 (101.0)	5.00 (127.0)	3.07 (78.0)	1.10 (28.0)	1.96 (50.0)	2.75 (70.0)	5.51 (140.0)	1.81 (46.0)	0.74 (19.0)	1.57 (40.0)	0.31 (8.0)	0.74 (19.0)	M8	.22 (5.7)	G1/8	2.24 (57.0)
SC040	4.00 (101.0)	5.00 (127.0)	3.07 (78.0)	1.10 (28.0)	2.36 (60.0)	2.95 (75.0)	5.51 (140.0)	2.16 (55.0)	0.74 (19.0)	1.89 (48.0)	0.31 (8.0)	0.74 (19.0)	M8	.27 (6.8)	G1/8	2.46 (63.5)
SC050	4.70 (119.5)	5.89 (149.5)	3.56 (90.5)	1.22 (31.0)	2.75 (70.0)	3.34 (85.0)	6.30 (160.0)	2.55 (65.0)	1.00 (25.4)	2.24 (57.0)	0.39 (10.0)	1.00 (25.4)	M10	.27 (6.8)	G1/8	2.76 (70.0)
SC063	4.70 (119.5)	5.89 (149.5)	3.56 (90.5)	1.22 (31.0)	3.25 (83.0)	3.74 (95.0)	6.30 (160.0)	3.07 (78.0)	1.00 (25.4)	2.64 (67.0)	0.39 (10.0)	1.00 (25.4)	M10	.35 (9.0)	G1/8	3.15 (80.0)

*With sensing magnet add 0.200 in.

**SC025 with Sensing magnet includes 4 M4 x 70mm SHCS for mounting.

MODEL	BORE SIZE	CLAMP FORCE	CLAMP FORCE	TOTAL STROKE	CLAMPING STROKE	SWING STROKE	MAX. M2 MOMENT
SC025	25mm	52 lbs.	231 N	0.86 in. (22.0 mm)	0.43 in. (11.0 mm)	0.43 in. (11.0 mm)	101.0 in.-lb. (6.2 Nm)
SC032	32mm	93 lbs.	413 N	1.02 in. (26.0 mm)	0.51 in. (13.0 mm)	0.51 in. (13.0 mm)	266 in.-lb. (16.3 Nm)
SC040	40mm	163 lbs.	726 N	1.02 in. (26.0 mm)	0.51 in. (13.0 mm)	0.51 in. (13.0 mm)	402.0 in.-lb. (24.7 Nm)
SC050	50mm	255 lbs.	1134 N	1.18 in. (30.0 mm)	0.59 in. (15.0 mm)	0.59 in. (15.0 mm)	700.0 in.-lb. (43.0 Nm)
SC063	63mm	434 lbs.	1930 N	1.18 in. (30.0 mm)	0.59 in. (15.0 mm)	0.59 in. (15.0 mm)	1300.0 in.-lb. (79.9 Nm)

Clamp force at maximum pressure 100 PSI (6.8 bars).



SC Series Switch Information

	SWITCH OR BRACKET DESCRIPTION	STANDARD PART NO.	QUICK DISCONNECT PART NO.
1	Hall Effect - PNP (Sourcing)	HPNPS31	HPNPQ31
1	Hall Effect -NPN (Sinking)	HNPNS32	HNPNQ32
1	Reed Switch	RSS02	RSQ02



RSS02 – Reed Switch (AC/DC NO), flying lead

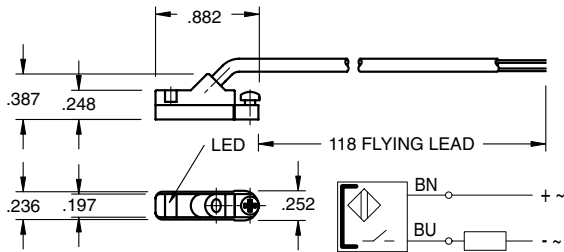

Sensing Data

Ambient temperature range T_a	(°F/°C)	-4 to 176 (-20 to 80)
Frequency of operating cycles f at U_e	(kHz)	0.5
Turn on time t	(ms)	≤ 0.25
Turn off time t	(ms)	0.03
LED function indication		yes

Electrical Data

Rated operational voltage U_e	(V)	3...130 AC/DC
Supply voltage U_B	(V)	3...130 AC/DC
Voltage drop U_d at I_e Stat./dyn.	(V)	3.5
Rated insulation voltage U_i	(V)	2750 DC (EN 60335-1)
Rated supply frequency	(Hz)	AC/DC
Rated operational current I_e	(mA)	50 (10W max.)
No-load supply current I_o at U_e d./und.	(mA)	0

Observe polarity for correct LED function

RSQ02 – 8mm connector

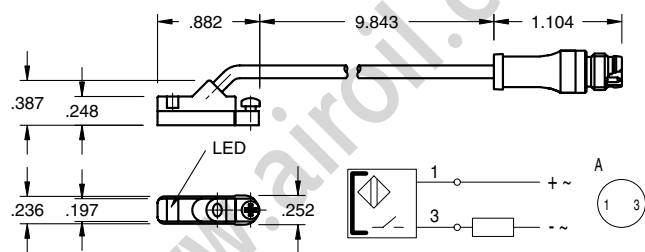

Mechanical Data

Housing material	Polyamide
Material of sensing face	Polyamide
Connection	PVC cable
Degree of Protection	IP 67
Rated shock: half-sinus	50g, 11 ms
Rated vibration environment	10g, 10...2000 Hz. 90 min



HPNPS31 – Electronic Switch (PNP NO), flying lead

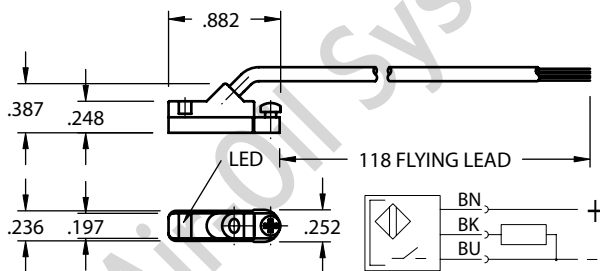

Sensing Data

Ambient temperature range Δ	(°F/°C)	-13 to +158 (-25 to +70)
Temperature drift	(% of)	$\leq 0.3\%/^{\circ}\text{C}$
Frequency of operating cycles f at U_e	(kHz)	10
Turn on time t	(ms)	.05
Turn off time t	(ms)	.05
Utilization categories		DC13
Function-supply voltage indication		YES

Electrical Data

Rated operational voltage U_e	(V)	24 DC
Supply voltage U_B	(V)	10...30 DC
incl. ripple	(% of U_e)	15
Voltage drop U_d at I_e Stat./dyn.	(V)	1/-
Rated insulation voltage U_i	(V)	75 AC
Rated supply frequency	(Hz)	DC
Rated operational current I_e	(mA)	200
No-load supply current I_o at U_e d./und.	(mA)	25/13
Protected against polarity reversal		YES



HPNPQ31 – 8mm connector

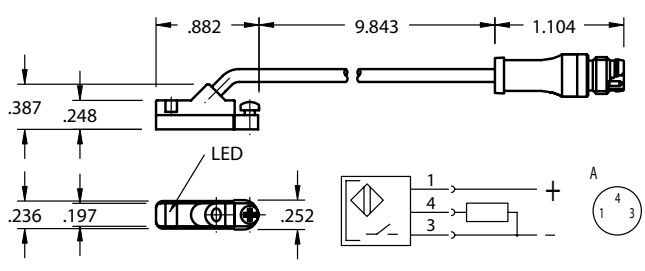

Mechanical Data

Housing material	Polyamide
Material of sensing face	Polyamide
Connection	PVC cable
Degree of Protection	IP 67
Rated shock: half-sinus	30 g, 11 ms
Rated vibration environment	55 Hz, 1mm amplitude, 3 x 30



SC Series Swing Clamps

NUMATICS®

HNPNS32 – Electronic Switch (NPN NO), flying lead

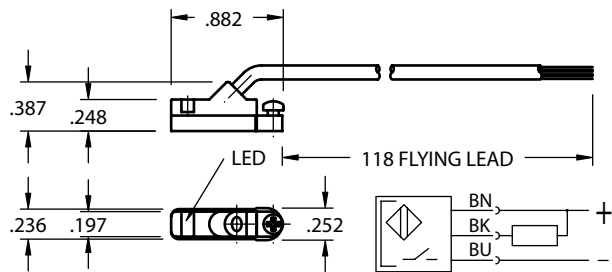

Sensing Data

Ambient temperature range t_d	(°F/°C)	-13 to +158 (-25 to +70)
Temperature drift	(% of S_r)	$\leq 0.3\%/^{\circ}\text{C}$
Frequency of operating cycles f at U_e	(kHz)	10
Turn on time t	(ms)	.05
turn off time t	(ms)	.05
Utilization categories		DC13
Function–supply voltage indication		YES

Electrical Data

Rated operational voltage U_e	(V)	24 DC
Supply voltage U_B	(V)	10...30 DC
incl. ripple	(% of U_e)	15
Voltage drop U_d at I_e Stat./dyn.	(V)	1/-
Rated insulation voltage U_i	(V)	75 AC
Rated supply frequency	(Hz)	DC
Rated operational current I_e	(mA)	200
No-load supply current I_o at U_e d./und.	(mA)	25/13
Protected against polarity reversal		YES

HNPNQ32 – 8mm connector

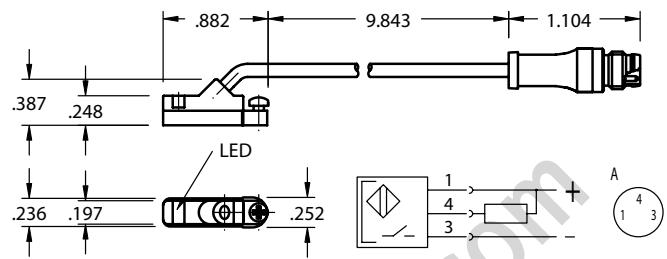

Mechanical Data

Housing material	Polyamide
Material of sensing face	Polyamide
Connection	PVC cable
Degree of Protection	IP 67
Rated shock: half-sinus, 30 g, 11 ms	
Rated vibration environment: 55 Hz, 1mm amplitude, 3 x 30	



Female Connectors for Reed Switches and Hall Effect Sensors

Dimensions (mm)

TYPE	ORDER CODE
Straight, 5 m Cable	PXCST
Elbow, 5 m Calbe	PXC90

Straight Type

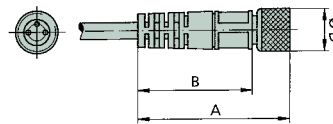

Elbow Type

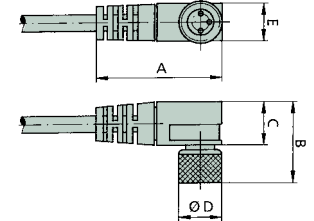

NUMATICS®

World Class Supplier
of Pneumatic Components



World Headquarters

Numatics Incorporated

Phone: 248-887-4111
Fax: 248-887-9190

UNITED STATES

Numatics – Air Preparation

Phone: 810-667-3900
Fax: 810-667-3902

Numatics – Valves

Phone: 248-887-4111
Fax: 248-887-9190

Numatics – Miniature Valves

Phone: 248-960-1400
Fax: 248-960-2160

Numatics – Cylinders

Phone: 615-771-1200
Fax: 615-771-1201

Numatics – Rodless Cylinders

Phone: 519-452-1777
Fax: 519-452-3995

Numatics – Automation

Phone: 440-934-3200
Fax: 440-934-2288

CANADA

Ontario

Numatics, Ltd.
Phone: 519-452-1777
Fax: 519-452-3995

Quebec

Numatics, Ltd.
Phone: 514-332-6444
Fax: 514-332-9273

British Columbia

Numatics, Ltd.
Phone: 604-574-0401
Fax: 604-574-3713

EUROPE

Germany – European Headquarters

Numatics GmbH
Phone: 011-49-22 41-31 60-0
Fax: 011-49-22 41-31 60 40

Hungary

Numatics Kft.
Phone: 011-36-13 82 21 35
Fax: 011-36-12 04 39 47

EUROPE

England

Numatics Limited
Phone: 011-44-1525-37 07 35
Fax: 011-44-1525-38 25 67

France

Numatics s.a.r.l.
Phone: 011-33-1 41 21 48 88
Fax: 011-33-1 41 21 48 89

Italy

Numatics srl
Phone: 011-39-030-373 19 99
Fax: 011-39-030-373 19 81

Netherlands

Numatics B.V.
Phone: 011-31-418-65 29 50
Fax: 011-31-418-65 29 43

Spain

Numatics Spain S.L.
Phone: 011-34-93-221 21 96
Fax: 011-34-93-221 35 14

AFRICA

South Africa

Numatics SA (Pty) Ltd.
Phone: 011-27-11-8 65 44 52
Fax: 011-27-11-8 65 42 90

LATIN & SOUTH AMERICA

Mexico

Numatics de Mexico S.A. de C.V.
Phone: 011-52-222-284 6176
Fax: 011-52-222-284 6179

Brazil

Valvair Comercial Ltda.
Phone: 011-55-12-351 2874
Fax: 011-55-12-351 1958

ASIA & PACIFIC

Australia

Numatics Australia Pty. Ltd.
Phone: 011-61-3-95 63 86 00
Fax: 011-61-3-95 63 85 11

Taiwan – Asian Headquarters

Numatics Co, Ltd. Asia
Phone: 011-886-2-29 15 16 05
Fax: 011-886-2-29 14 18 97

For a comprehensive listing of all Numatics production and distribution facilities worldwide, visit www.numatics.com